

PORT GRIMAUD INFO

ISSUE 8

Questions and answers • Spring 2025

A Word from the Mayor

Ladies and Gentlemen,

Dear residents, dear boat owners,

Port Grimaud, an architectural and maritime gem, is an exceptional place whose uniqueness is a source of collective pride.

Today, we stand at a turning point in its history: preserving its identity while securing its future.

I am pleased to see that our port authority continues its sound management while remaining true to Port Grimaud's unique identity. The results of the past year reflect rigorous and efficient management, once again showing a surplus—where previous administrations consistently recorded chronic deficits.

Once again, last February, the Administrative Court upheld the Municipality's position regarding its management model. That is why we will continue our efforts to ensure balanced management.

Now more than ever, I want to reaffirm my commitment: Port Grimaud must remain as François Spoerry envisioned it— «A house, a private quay, and a boat mooring in front.»

This has always been my goal, and I will continue to defend it with determination.

I am deeply convinced that it is possible to strike a balance between the essential maintenance of infrastructure, securing mooring rights, and implementing solutions that address the environmental challenges at the heart of our efforts.

Together, through dialogue, we must work to preserve and strengthen this exceptional place that is so dear to us all.

Alain BENEDETTO

Mayor of Grimaud



Let's untangle the truth from the lies about the future of Port Grimaud

Given all the different information circulating about the future of our port and its current projects, it's essential to separate facts from rumours. Here are a few factual responses to correct all the baseless falsehoods.

The Municipality wants to expropriate the co-ownership associations

FALSE

- > No expropriation proceedings have been undertaken. The Municipality is only requesting the transfer of the assets used by the former concessionaires as part of the port's public service, in accordance with the rules in force.

The Municipality is seeking to speculate on Port Grimaud

FALSE

- > The Municipality is neither a real estate developer nor property dealer. Its role is to ensure the proper management of the marina by improving its infrastructure and the quality of its services.

The internal roads are required to become public

TRUE

- > If no solution is found to allow access for the Capitainerie team the Municipality will have no choice but to integrate the roads of Port Grimaud into the public domain. However, at its request, an alternative solution is being discussed with the ASL: the establishment of a conventional easement that would allow the roads to retain their private status while ensuring access to the port service.

The "Port Grimaud 2030" project must be environmentally friendly

TRUE

- > Any plans must comply with strict regulations and obtain prefectural authorisation. Only projects that guarantee environmental protection will be approved.

Consultation with residents was too short.

FALSE

- > In total, there were nearly five months of consultation, including a three-month pre-consultation before the official consultation.

The water can be dredged while respecting the canal infrastructure

TRUE

- > The aim is simply to return to the original depth, without digging it out any further. So this won't affect the stability of the structures.

Boat size has increased since the takeover

FALSE

- > Since 2022, the size and power of boats moored in the port hasn't changed. Registration data proves this.

Mooring in front of houses will continue

TRUE

- > The proposed usage guarantee contract the Municipality is working on aims to secure this right for owners for a period of 35 years.

The elements of the business consultation established in 2023 continue to provide a working basis for the Municipality

FALSE

- > The elements designed in this consultation document were used to select a group of companies to provide project management assistance. This document is therefore no longer used. The only projects studied by the Municipality are the ones selected following the consultation:
- Redevelopment of the Church landing stage according to project no. 3 (JANIN)
 - Remodelling the entrance pass dykes based on scenarios 1 and 1a
 - Redevelopment of the Harbour Master's Office according to scenario no. 1 (X. BOHL)

All other projects and associated documents are obsolete and should no longer be used.

Outer harbor development

- > Scenario 1: North and South extension - approx. 27 M€ HT (excluding excluding contingencies)
- > Scenario 1bis: North and South extension + Giscle - approx. 29 M€ HT (excluding contingencies)

1 bis

Restructuring the church purlin. Scenario n°3 by JANIN, selected during the consultation process.

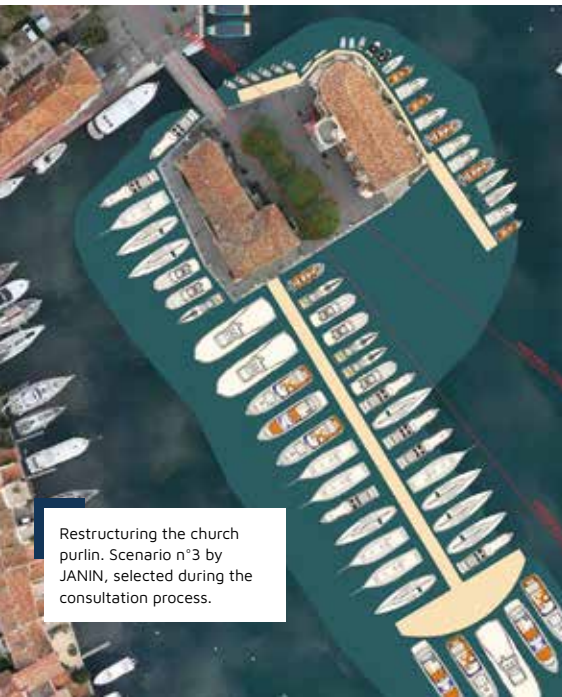

The Harbour Master's Office extension project will be the one validated during consultation

TRUE

> The current building is no longer up to standard and needs modernising. That's why the harbour master's office will be completely redesigned according to the outline put forward by Xavier BOHL, which was selected during consultation. This project

includes an extension, but without creating an additional level or visual impact. What's more, annex premises are also planned at PG2 and PG3 for better management.

FALSE

Raising the dykes will spoil the view

> Visual aids have shown there will be no visual impact on homes.

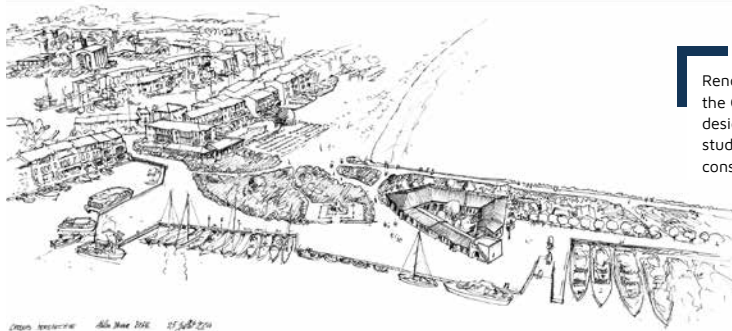

Renovation and extension of the Capitainerie. Scenario n°1 designed by the Xavier BOHL studio, selected during the consultation process.



In conclusion :

The current projects aim to ensure the sustainability of Port Grimaud by combining modernisation, security and respect for the environment.

We remain attentive and engaged to shape the future of our port together.



Permanence without appointment
every Wednesday afternoon
at the harbor master's office from 2 p.m.

Informations & inquiry:

+33 (0)4 94 56 29 88
capitainerie@portdegrimaud.fr